

OPENING DOORS SINCE 1843

Loveitts<sup>est. 1843</sup>  
THE ESTATE AGENTS



Blythe Road  
Coventry, CV1 5AU

**£140,000**





Blythe Road

Coventry, CV1 5AU

This two bedroom mid terraced property is located in Hillfields, Coventry and is an ideal investment opportunity for buy to let investors, or first time buyers looking to purchase their first property.

In summary the property briefly comprises porch leading into lounge, fitted kitchen and store room off the kitchen. To the first floor the property has two bedrooms and a family bathroom. The house benefits from a rear garden, gas central heating and double glazing throughout.

The position of the house stands within walking distance of Coventry City centre, is close to excellent road links and bus routes and comes with vacant possession. The property is in need of some improvment.

To arrange a viewing contact Loveitts on 024 76 258 421.

If you're looking to sell your property please contact us here for a FREE Market Appraisal <https://valuation.loveitts.co.uk/home/835-loveitts>







- Mid Terraced house
- One Reception room
- Fitted Kitchen
- Upstairs Bathroom
- Two Bedrooms to first floor
- Rear Garden
- Double Glazing
- Gas Central Heating
- Ideal investment opportunity
- Vacant Possession



Floor Plan

Area Map

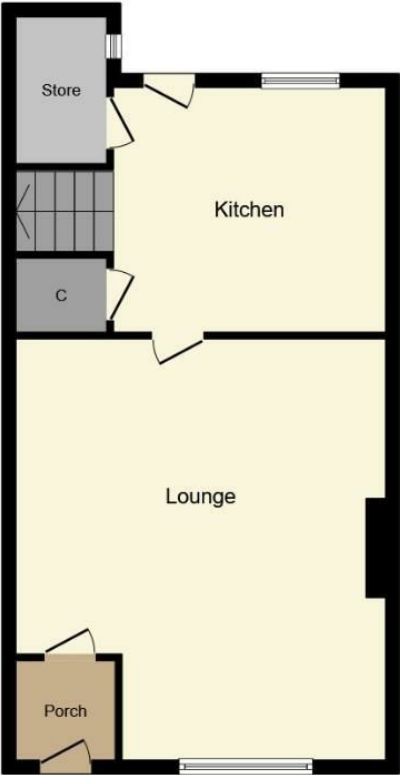

Ground Floor

Floor area 58.5 sq.m. (629 sq.ft.) approx

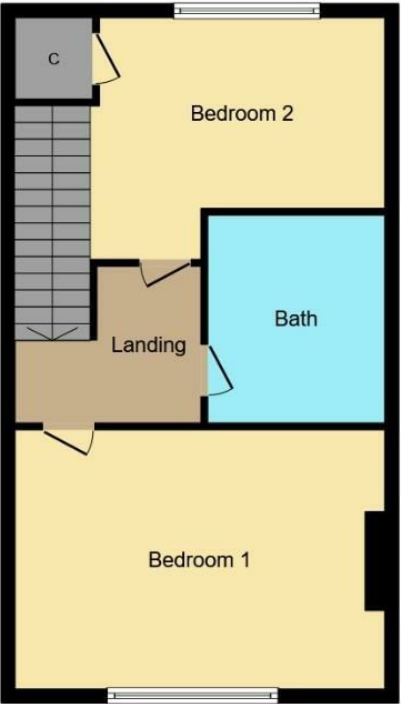

First Floor

Floor area 56.9 sq.m. (612 sq.ft.) approx

Total floor area 115.4 sq.m. (1,242 sq.ft.) approx

This Floor Plan is for illustration purposes only and may not be representative of the property. The position and size of doors, windows and other features are approximate. Unauthorized reproduction prohibited. © PropertyBOX



Energy Efficiency Rating

	Current	Potential
Very energy efficient - lower running costs		
(92 plus) <b>A</b>		<b>91</b>
(81-91) <b>B</b>		
(69-80) <b>C</b>	<b>76</b>	
(55-68) <b>D</b>		
(39-54) <b>E</b>		
(21-38) <b>F</b>		
(1-20) <b>G</b>		
Not energy efficient - higher running costs		
<b>England &amp; Wales</b>		EU Directive 2002/91/EC

These particulars, whilst believed to be accurate are set out as a general outline only for guidance and do not constitute any part of an offer or contract. Intending purchasers should not rely on them as statements of representation of fact, but must satisfy themselves by inspection or otherwise as to their accuracy. No person in this firm or employment has the authority to make or give any representation or warranty in respect of the property.



Coventry  
29 Warwick Row, Coventry CV1 1DY  
024 7625 8421

Registered in England & Wales Company no. 7558151